

Yaw Pitot-T

Yaw Pitot Pressure tube

SN: P#####

Texense sensors are designed for data logging. Should the users want to include this sensor in a closed loop system, they must undertake total responsibility from doing so.

Common			
Dimension	See drawing		
Material	Aluminium and stainless steel		
Weight	150mm tube	55	g
	300mm tube	78	
Housing Protection	IP64		
Vibration test	20Gpp5'		
Shock	500		G
Operating Temp	+5 to +85		°C
Storage Temp	-40 to +125		°C
Pressure ports			
Standard ports tube Ø	1		mm
Optional SPP tube Ø	1.6		mm

Date		Operator	
Customer			
Order			
Product Ref	Yaw Pitot-T-###-##		

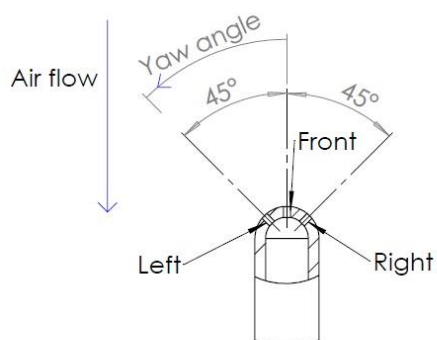

$$\text{Yaw angle} = f((P_{\text{left}} - P_{\text{right}}) / (P_{\text{front}} - P_{\text{static}}))$$

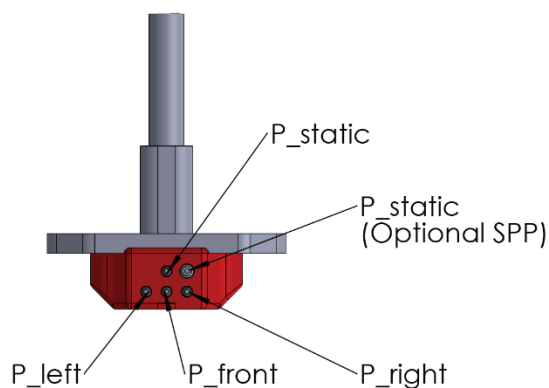

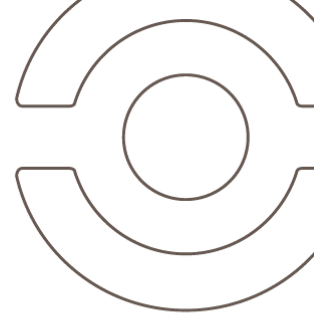

Mechanical drawing

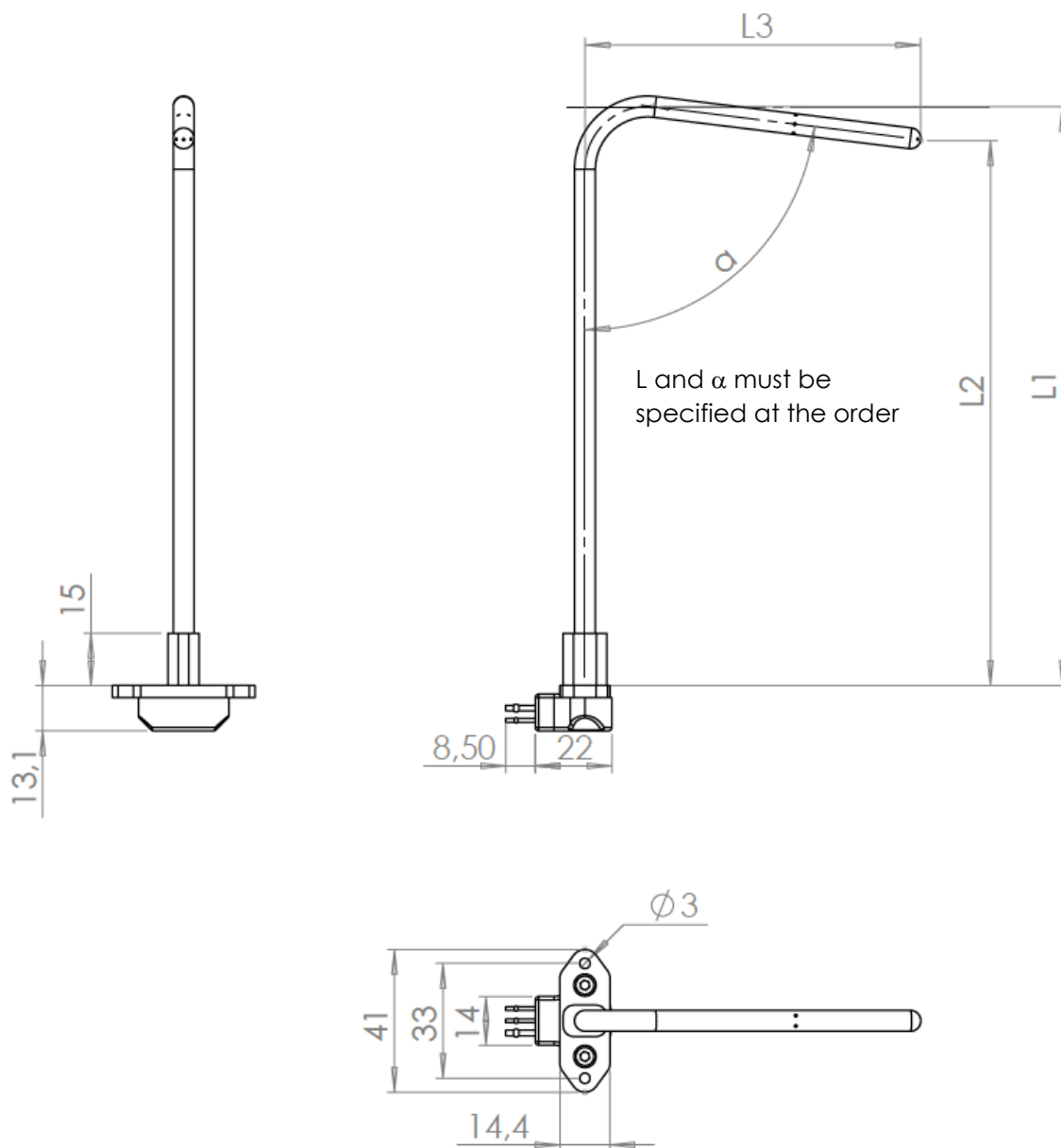

L (mm) ordering	α (°) ordering	L1 (mm)	L2 (mm)	L3 (mm)
150.0	90.0	150.0	150	93
150.0	80.0	150.0	134	92
150.0	70.0	150.0	117	87
300.0	90.0	300.0	300	93
300.0	80.0	300.0	284	92
300.0	70.0	300.0	267	87

Accuracy:

- Length: $\pm 2\text{mm}$
- Angle: $\pm 1^\circ$

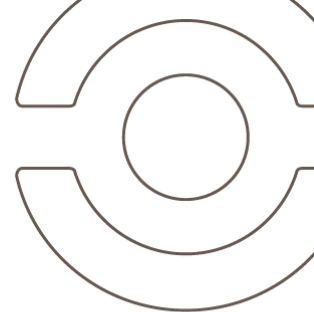

Orientation options



Standard orientation



Inverted orientation
"I" code option

Ordering information

Ordering ref:

Yaw Pitot-T – *Inverted Option* – Length – Angle – SPP(option)

I: Inverted orientation

SPP: Static Pressure Port output

Tube length in mm
standard 150mm or 300mm

Tube angle in °: from 65° to 90° (standard 90°)

ex: Yaw Pitot-T-150-90
Yaw Pitot-T-I-300-80-SPP